



WELCOME TO ASK ENGINEERS

ASK





ASK ENGINEERS
(AN ISO 9001:2015 COMPANY)

**An Established Leader
of Innovative manufacturing methods
in modern machining**

A revolution in accuracy driven by perfection

ABOUT ASK

Establishment Year: 2001

Ownership Structure :

- Partnership Firm
- **Board :**
 - Mr. Santosh Hegade
 - Mr. Ajay Hegade

Certifications :

- ISO 9001:2015 from TUV Nord, Germany

Facility :

- Unit I Area : 20,000 sq. ft.
- Unit II Area : 50,000 sq. ft.
- Unit III Area : 64000 under construction

Warmest Greetings from ASK ENGINEERS.

❖ Company Profile :

- A High-Tech Precision Machined components manufacturer and assemblies as per customer drawings and specifications.
- State-of-the-art Machining & inspection equipment

Materials:

- We machines various materials grade like – Forging, Casting , Inconel, Monel, 17-4ph , Stellite, SS316 , Duplex , Ductile Casting , Aluminum Bronze and Aluminum etc.

In addition to the above, we have tie-up with outsource facilities like All types Heat Treatment , Coatings – Xylan, Phosphating, Zinc, Anodizing , Platings – Zinc, Hard Chrome plating, QPQ Nitriding & Sand Blasting in Pune .

We have successfully completed Lean Manufacturing Cluster(24 Months) Under Govt. of India-MSME-QCI Scheme from March 2017 to May 2019.

We are proud to state that we are directly exporting our various products to USA, with the help of our dedicated Engineers and skilled work force.

QUALITY & CUSTOMER SATISFACTION IS OUR PRIME MOTTO.



□ **ASK CORE VALUES**

1) CUSTOMER URGENCY ABOVE ELSE

2) NO COMPROMISE IN QUALITY

3) HARD WORK BY HEART

4) SELF UPGRADATION



❖ Added new global customer, manufacturing of hydraulic cylinders. We supplied major Cylinder parts for Telescopic Cylinder. ASK was the single source for

❖ Entered in to oil & gas industry part machine.

❖ Customer requested us for fully assembled finished parts (Rear Axle Tube for commercial Vehicle) Added equipment's and Infra.

❖ Started supply pre-machined components For Axle assemblies to TATA Motors (3000 per month)

❖ Start with conventional lath M/C. Started supply to tyre3 vender for automotive. In 2002 taken ISO certificate .

2001

2003

2005

2007

2009



Company Development

□ We aim to add the latest equipment and Industry 4 before 2025...



❖ Started Direct Export Business to USA.

We developed full Hydraulic cylinder assembly As per customer drawing.

2012

❖ Added heavy machines equipment's Like MAZAK, MORI Seiki DOOSAN . Developed oil and gas domestic ULTRA, T3 ENERGY, PRIMIUIM Oilfield USA, VALVEWORKS.

2015

❖ ASK demerged in to Two companies. Like ASK ENGINEERS & ASK INDUSTRY. Oil & Gas Industry and Heavy Products are With ASK Engineers and All others small parts are with demerged Company .

2019

❖ After Covid-19 team ASK ENGINEERS focused on New Part Development, from Jun 2020 to Dec 2021 ASK has developed very critical parts like Plug Valve Bodies, Plugs, Insert Sets, Seal Segment for various customers of OIL & GAS SECTOR. Also ASK has developed critical Machining parts like Saddle & Beam of Electrical Trucks for MITSUBUSHI FUSO, JAPAN.

2021

Road Map For Year 2022-23

Activity Name	Target
1) New Plant Expansion in 50000 Sq.ft. Area	October 2022
2) DMU50 V VMC 5th Axis	October 2022
3) Mori Seiki MT253/1500 Milling and Turning Center	October 2022
4) Doosan HMC – Pallet Size 1000 X 1000 with all axis glass scale.	November 2022
5) Doosan Make VMC – 2160 X 760 with all all axis glass scale.	November 2022

□ PRODUCT & SECTORS

We supply Parts and Assemblies to the following sectors :

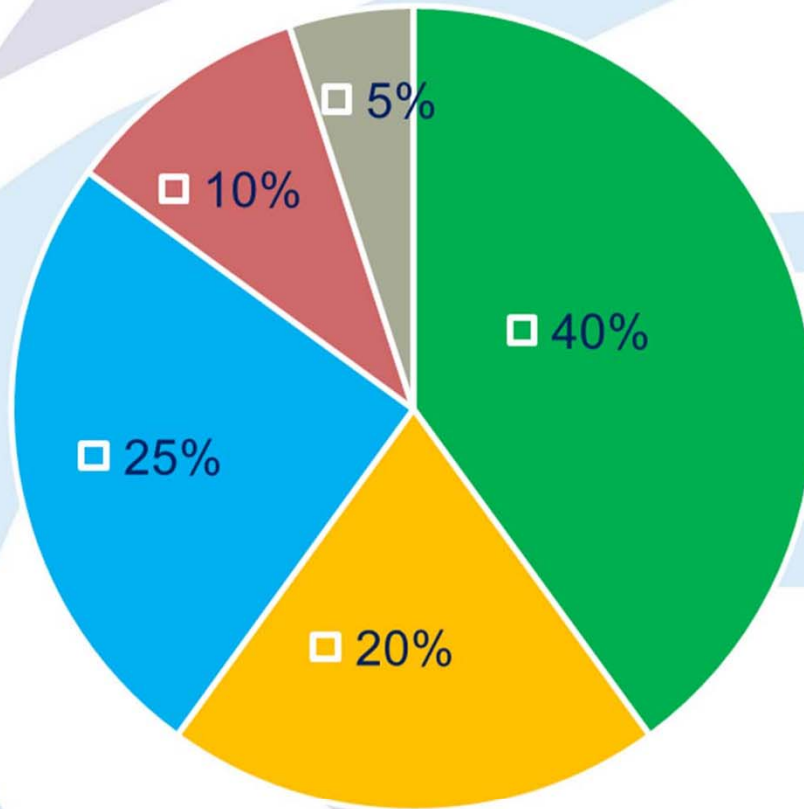

■ OIL & GAS

■ RAILWAY

■ AUTOMOBILE

■ POWER & ENERGY

■ DEFENCE





ISO CERTIFICATE

TUV NORD

CERTIFICATE

Management system as per
ISO 9001 : 2015

In accordance with TÜV INDIA procedures, it is hereby certified that

ASK ENGINEERS
Plot No. 268, 269 & 270, Sector No.10,
PCNTDA, MIDC, Pune – 411 026,
Maharashtra,
India

applies a management system in line with the above standard for the following scope

**Manufacture & Supply of Precision Machined & Fabricated
Components, Sub-Assemblies.**

Certificate Registration No. QM 03 02140
Audit Report No. Q 6003/2014

Valid until 27.01.2024
Valid from 23.02.2021
Initial Certification 28.01.2018

Certification Body
at TÜV INDIA PVT. LTD.

Issue 23.02.2021
Place : Mumbai

This certification was conducted in accordance with the TÜV INDIA auditing and certification procedures & shall be valid subject to regular Surveillance Audits.

TÜV India Pvt. Ltd., 801, Rajaje Plaza – 1, L.B.S. Marg, Ghatskopar (W), Mumbai - 400 086, India cert.helpdesk@tuvindia.co.in



LIST OF MACHINERIES

Sr.No.	Machine Name	Make	No. of M/C	Specification
1	HMC	Mazak Nexus 8800II	1	Pallet Size 1000 X 1000 X1400, Y1250, Z1275
2	HMC	Mazak F68	3	Pallet Size 630 X 630 X1050 Y800 Z850
3	HMC	Mori Seiki	1	Pallet Size 630 X 630
4	HMC	Mori Seiki	2	Pallet Size 500X 500
5	VMC 5 th Axis	OKK	1	X 3000 Y 850 Z 850
6	VMC 5 th Axis	DMU50 V	1	X 500 Y 380 Z 380
7	VMC 5 th Axis	LMW	1	X 800 Y 500 Z550
8	VMC 4 th Axis	Moriseiki / ENSHU	2	X 850 Y 550 Z 550
9	VMC 4 th Axis	LMW DMV60	2	X 650 Y 500 Z550
10	VMC 4 th Axis	Doosan	1	X 1050 Y 650 Z 550
11	CNC Turnmill	Moriseiki / Doosan	2	800MM – 2200MM
12	CNC Turning	Mazak QTN 450II (200 U) & others	15	800MM – 2000MM
13	CNC Grinding	Phoenix Automation	1	250MM – 1000 MM
14	Lapping Machine	Lapmaster	1	1200MM – 500MM
15	Center Less Grinding	Malcus	1	Max Dia 160.0 MM

❑ MACHINE PHOTOS

Mazak Nexus 8800II



❑ CNC Turning Mazak QTN 450II (2000U)





□ HMC
Moriseiki



□ CNC
Turnmill
Doosan

□ LIST OF INSTRUMENTS

Sr No.	Instrument/Gauges Name	No of Ins.	Range	Least Count [mm]	
1	CMM	1	1000,800,600mm	0.0001	Accurate
2	Contour Tracer	1	X 100mm, Z 550mm	0.002	Zeiss Accretech
3	3D Scan	1	10 Meter	0.018	Scantech
4	Air Gauge	1	4-200mm	0.0001	Accurate
5	Surface Finish Tester	1	-	0.01	Mitutoyo
6	Digital Height Gauge	1	0-600 mm	0.001	Mitutoyo
7	Digital Micrometers	1	0-150 mm	0.001	Mitutoyo
8	Bore Gauges	4	6-350 mm	0.001	Mitutoyo
9	Vernier	1	0-600 mm	0.02	Mitutoyo
10	Depth Vernier	1	300 mm	0.02	Mitutoyo
11	Dial Vernier	1	0-300mm	0.02	Mitutoyo
12	Vernier Calipers	3	300 mm	0.02	Mitutoyo
13	Bench Center	1	0-1000mm	-	MMT
14	Plunger Dial Gauge	1	0-1.0mm	0.001	Mitutoyo
15	Plunger Dial Gauge	1	0-10 mm	0.01	Baker
16	Lever Dial Gauge	1	0-0.8 mm	0.01 mm	Mitutoyo
17	Dial Snap Gauges	2	0- 125 mm	0.01	Mitutoyo
18	Slip Gauge Set	1	0.05-100mm	-	Peacock
19	Surface Plate	3	up to 1000MM	-	Jafuji
20	Micrometer	3	0-300 mm	0.01	Yamayo
21	Blade Type External Micrometer	3	25-125 mm	0.01 mm	Mitutoyo
22	Inside Calipers	3	15-250 mm	0.01 mm	Teclock
23	Rockwell Hardness Tester	1	-	-	OTM / OTRB
24	Coating Thickness Meter	1	0-1250 μ m	0.001 mm	Elcotest- FNF
25	Engineers Square	1	330 X 175	-	Kristeel
26	Angle Protector	1	0°-180°	1°	Kristeel
27	Level Indicator (Angle Protector)	1	0°-180°	1°	-
28	Lux Meter	1	2000-100000 lux	1-100 LUX	MEXTECH

☐ MEASURING INSTRUMENTS

CMM ACCURATE WITH RENISHAW 1000x800x600



□ MEASURING INSTRUMENTS

CONTOURE TRACER



☐ MEASURING INSTRUMENTS



VISION MEASURING



PORTABLE SCANNING



SURFACE FINISH TESTOR

□ COMPONENTS PHOTOS

STUDED TEE

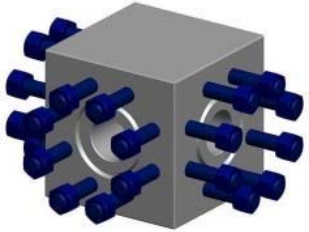

VALE BODY



VALVE BODY



CROSS



CONNECTING ROD



CONROD



BONNET



BEARING CAP



HAMMER NUT



SEAT RETAINER



SEAL RING & GASKETS



TURNING FORK



LOCKING SCREW



STEM ADAPTER



PLUG VALVE INSERT



ROLLER



SHELL BODY



WORM GEAR



GATE, STEM, BODY BUSHING



WELDNECK FLANGE



CAP END COVER



□ COMPONENTS PHOTOS

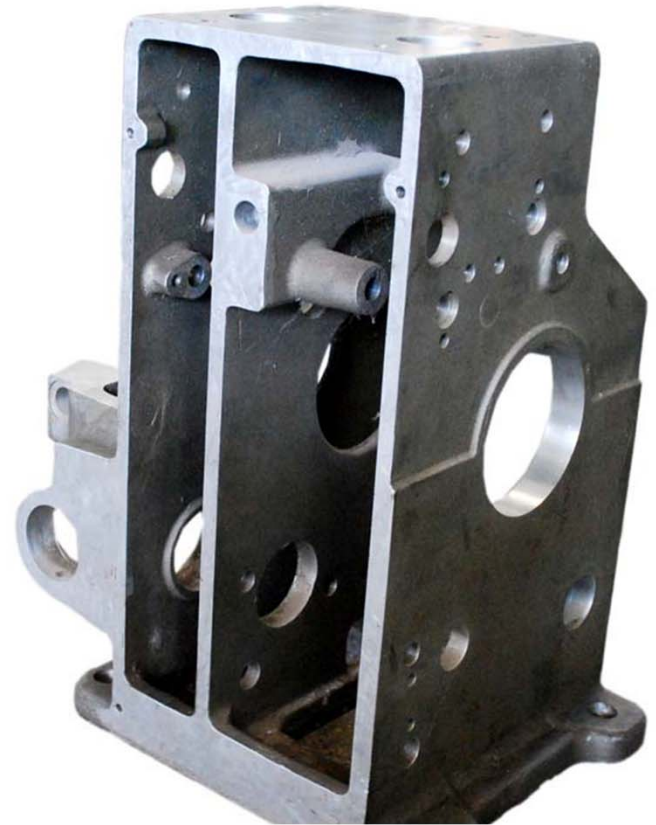

AXLE TUBE

□ COMPONENTS PHOTOS

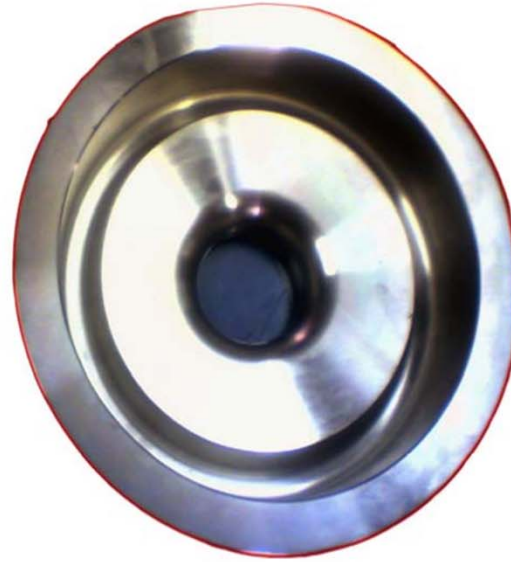

□ SHOP FLOOR PHOTOS



❑ ASK CSR ACTIVITY

- We starts our New Year celebration by donating blood, which gives 3 lives by one donor .We donate blood twice in every year, that is on 1ST Jan & 18th June.
- We have done tree plantation at Pingori village in 2016 and planted 2000 trees by our team.
- We also Started Eye donation camp with Jaguriti Social Foundation and as on today we have submitted 55 Eye Donation forms.

☐ BLOOD DONATION CAMP PHOTOS





**WE ARE IN
PROCESS OFF**

**● API Q1, TS 29001, ISO14001
Certification.**

□ OUR MISSION



**COST QUALITY & OTD
(ON TIME DELIVERY)**



THANK YOU

धन्यवाद 

THANK
YOU 

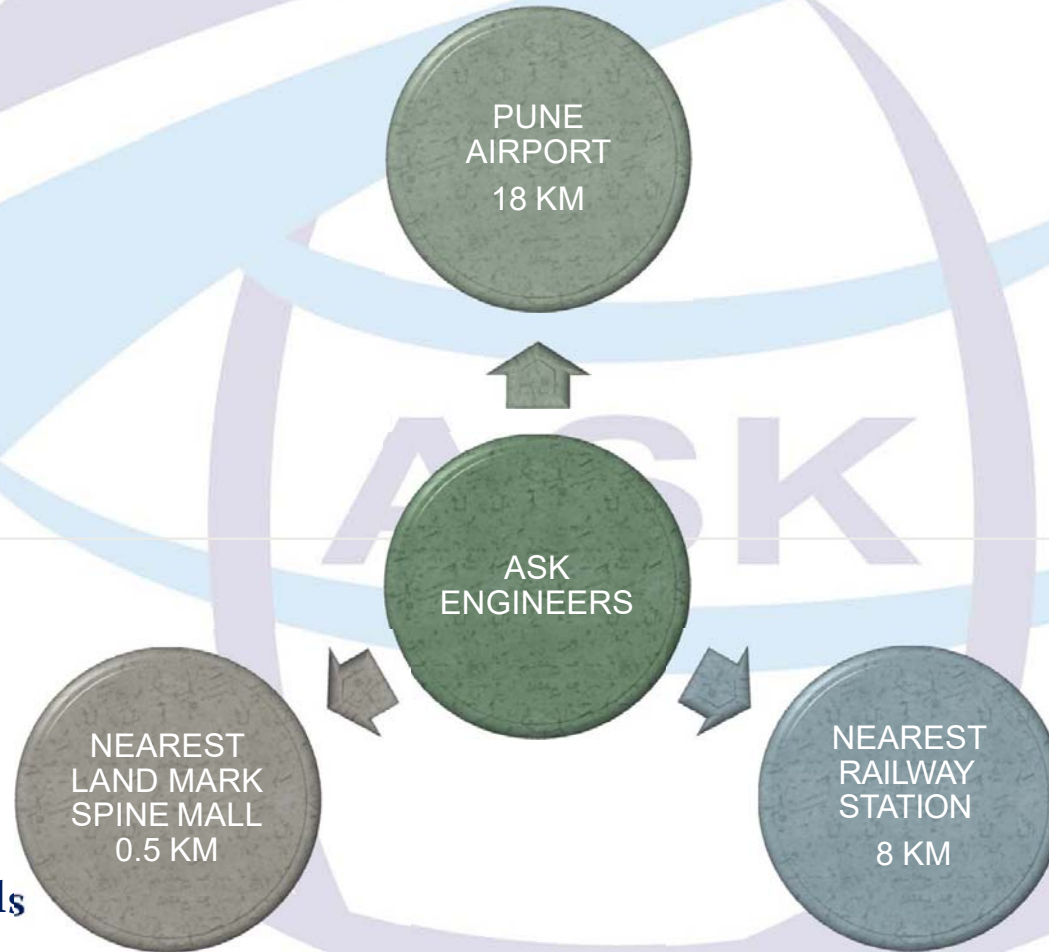

Contact Details

Mr. Santosh M. Hegade

Contact Number : +91 9921161117

Email Us : santosh.hegade@askgroupindia.com

Mr. Ajay M. Hegade

Contact Number : +91 9921161119

Email Us : admin@askgroupindia.com

Office & Factory Address:-

ASK ENGINEERS

Plot No – 268/269/270 , Sector -10 ,
PCNTDA , MIDC , Bhosari , Pune
Maharashtra- 411026 , India

Tel : +91-020-66302117

Website : www.askgroupindia.com